

EMI 磁珠

Ferrite Bead

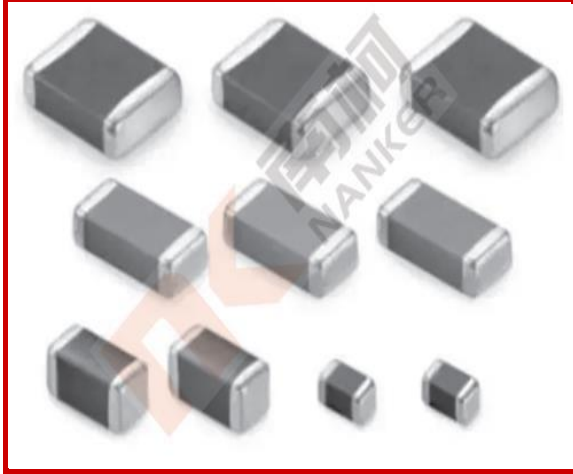

特性

Characteristics

可靠的镍锡电极

Reliable Ni-Sn electrodes

高额定电流高达10 A

High rated current up to 10 A

工作温度：-55°C至+125°C

Operating temperature: -55 °C to +125 °C

应用

Application

完美的数据线滤波器和配电电压解耦

Perfect as data line filter and for uncoupling of distribution voltage

产品品名介绍

Product Number Structure

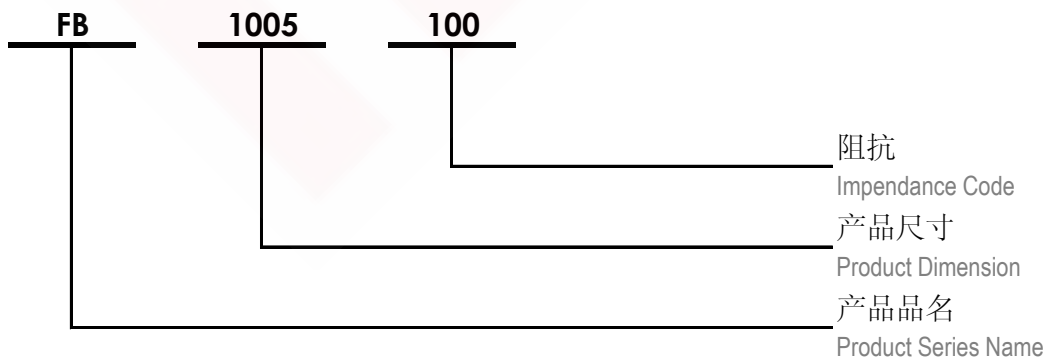



尺寸

Dimension (mm)

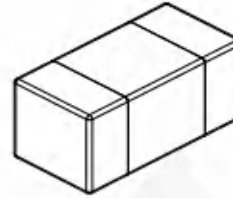
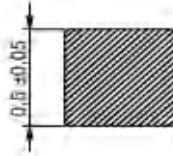
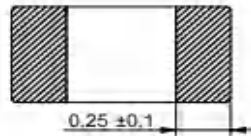
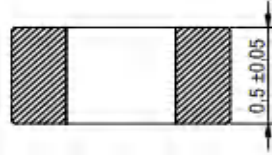
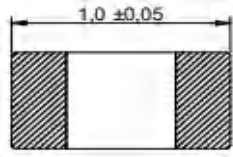

焊盘推荐

Land Pattern Recommended (mm)

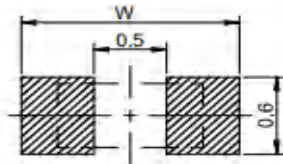

WIDE BAND / HIGH SPEED: W = 1.5
HIGH CURRENT: W = 2.2



示意图

Schematics



电性特性

Electrical Properties

型号 Part No.	阻抗 Impedance Z (Ω)	温升电流 Rated Current I _R 40°C (mA)	直流电阻 DC Resistance DCR _{max} (Ω)	卷盘数量 Taping Reel Qty. pcs
FB1005-100	10 ±25%	3,500	0.050	15,000
FB1005-300	30 ±25%	1,600	0.250	
FB1005-400	40 ±25%	1,700	0.300	
FB1005-600	60 ±25%	1,250	0.350	
FB1005-700	70 ±25%	800	0.150	
FB1005-800	80 ±25%	850	0.250	
FB1005-120	121 ±25%	1,100	0.200	
FB1005-180	181 ±25%	900	0.300	
FB1005-220	221 ±25%	900	0.350	
FB1005-240	241 ±25%	710	0.700	

测试状态

Test Condition

☆ 阻抗测试条件为 100MHz (25°C)

Impedance measure condition at 100MHz (25°C)

☆ 工作温度: -55°C ~ +125°C

Operating Temperature: -55°C ~ +125°C



尺寸

Dimension (mm)

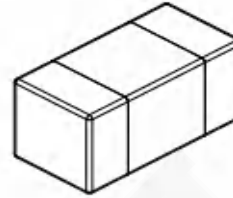
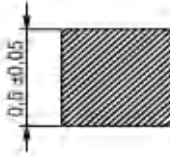
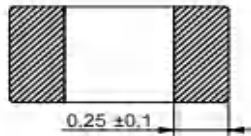
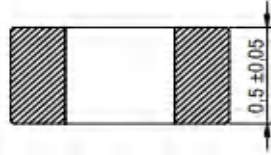
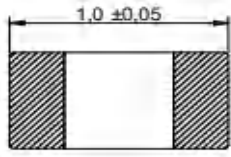

焊盘推荐

Land Pattern Recommended (mm)

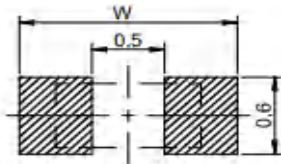

WIDE BAND / HIGH SPEED: W = 1.5
HIGH CURRENT: W = 2.2



示意图

Schematics



电性特性

Electrical Properties

型号 Part No.	阻抗 Impedance Z (Ω)	温升电流 Rated Current I _R 40°C (mA)	直流电阻 DC Resistance DCR _{max} (Ω)	卷盘数量 Taping Reel Qty. pcs
FB1005-301	300 ±25%	700	0.800	10,000
FB1005-471	470 ±25%	550	0.650	
FB1005-601	600 ±25%	550	1.000	
FB1005-801	800 ±25%	500	0.800	
FB1005-102	1,000 ±25%	550	1.500	

测试状态

Test Condition

☆ 阻抗测试条件为 100MHz (25°C)

Impedance measure condition at 100MHz (25°C)

☆ 工作温度: -55°C ~ +125°C

Operating Temperature: -55°C ~ +125°C



典型阻抗特性

Typical Impedance Characteristics

FB1005-100

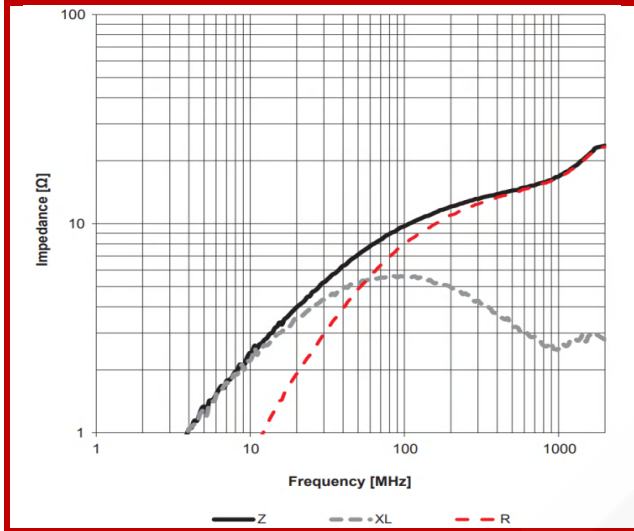

FB1005-300

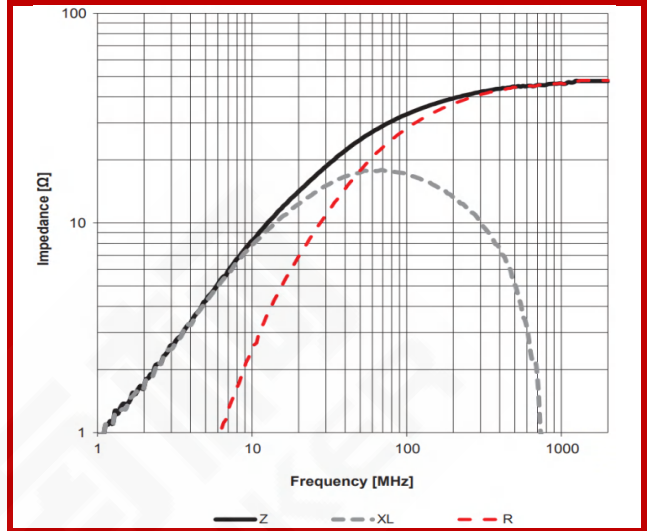

FB1005-400

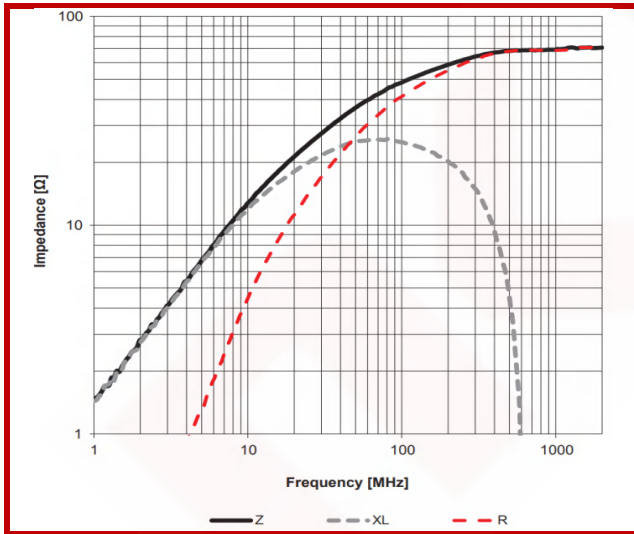

FB1005-600

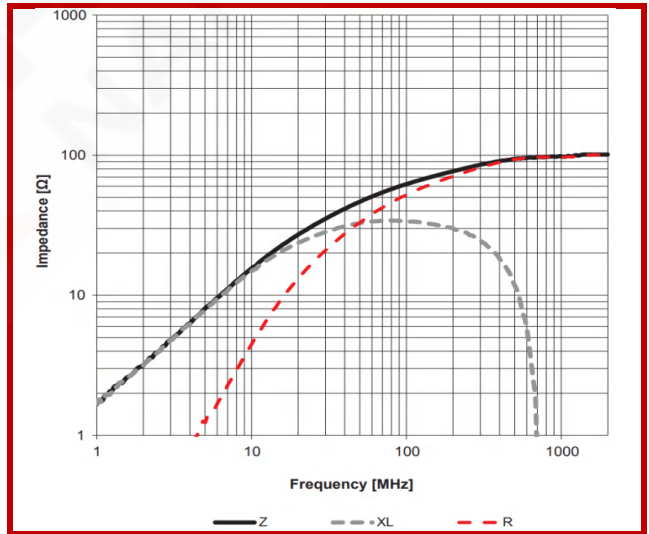

FB1005-700

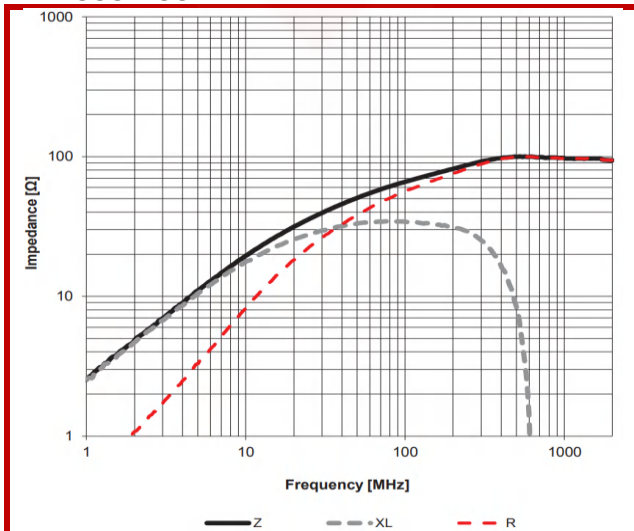

FB1005-800

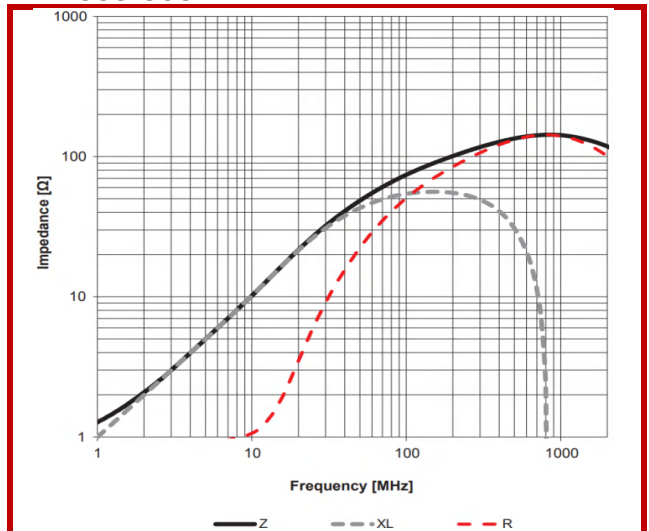



典型阻抗特性

Typical Impedance Characteristics

FB1005-120

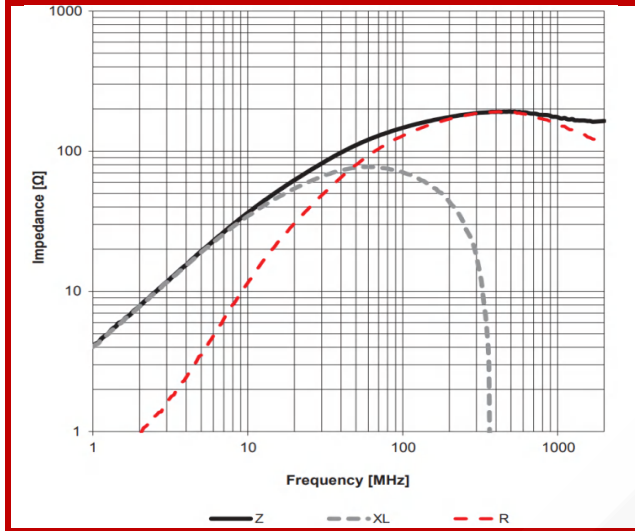

FB1005-180

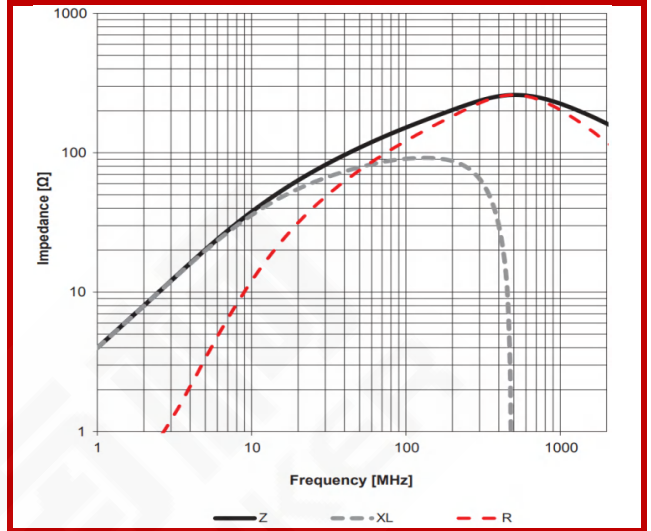

FB1005-220

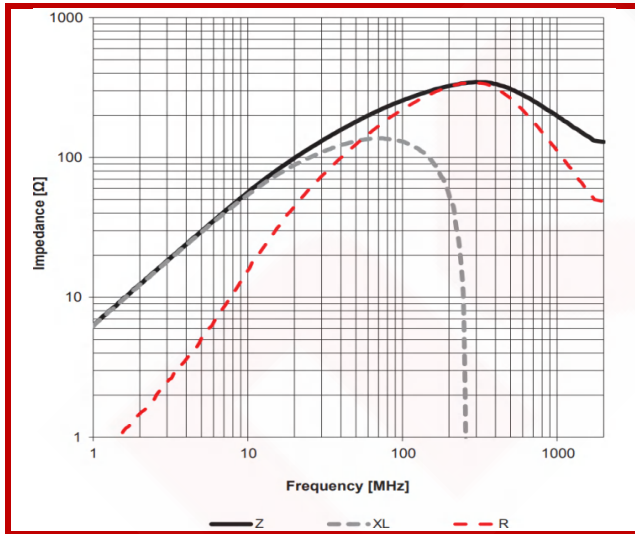

FB1005-240

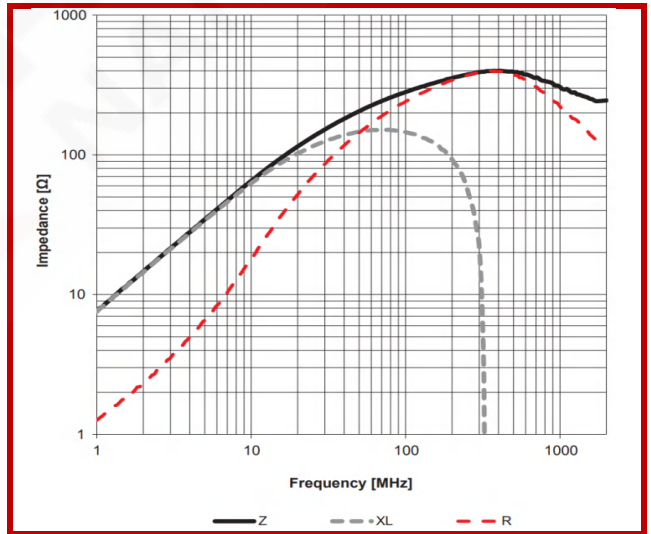

FB1005-301

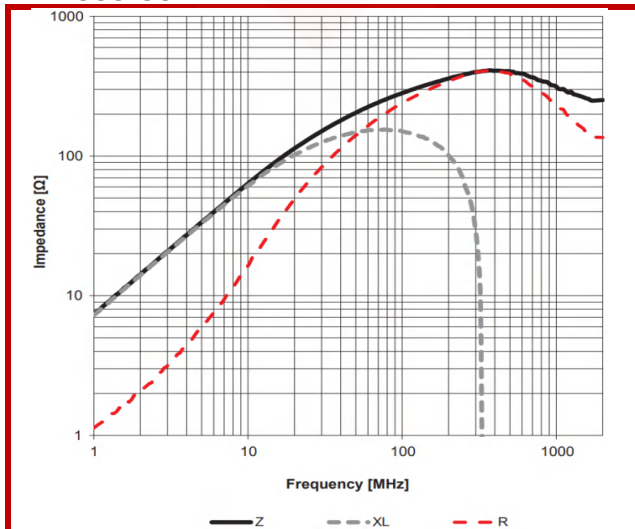

FB1005-471

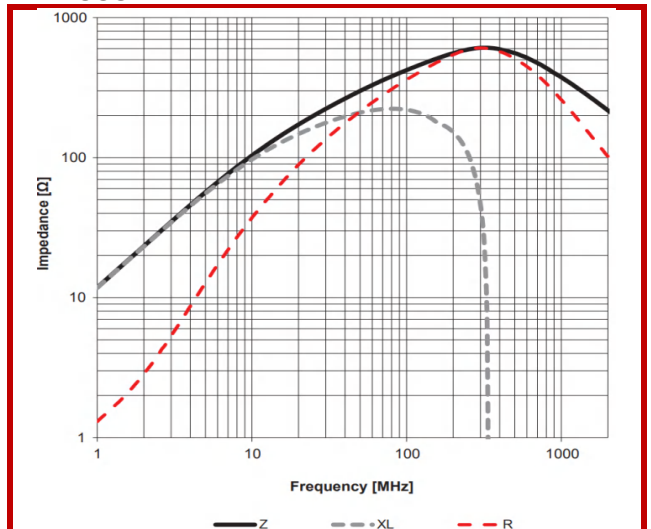



典型阻抗特性

Typical Impedance Characteristics

FB1005-601

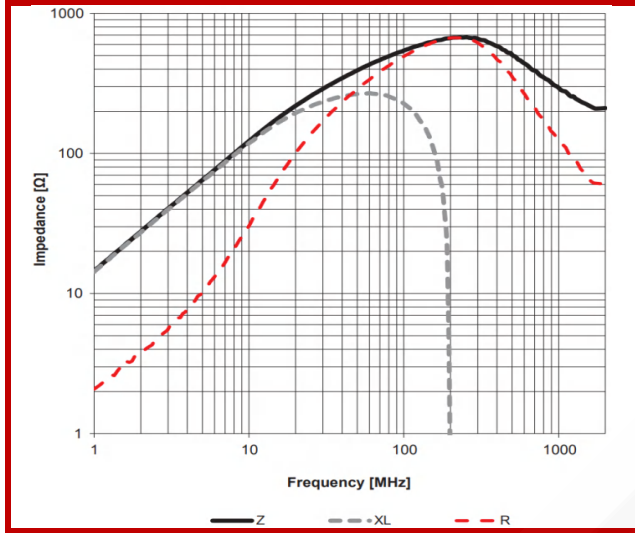

FB1005-801

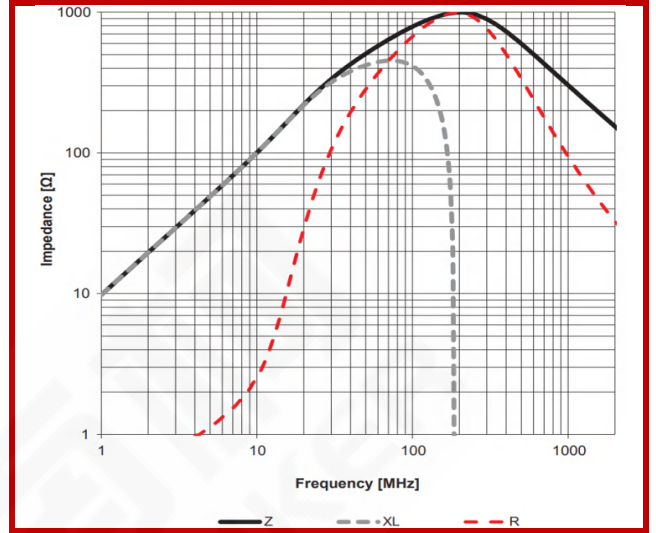

FB1005-102

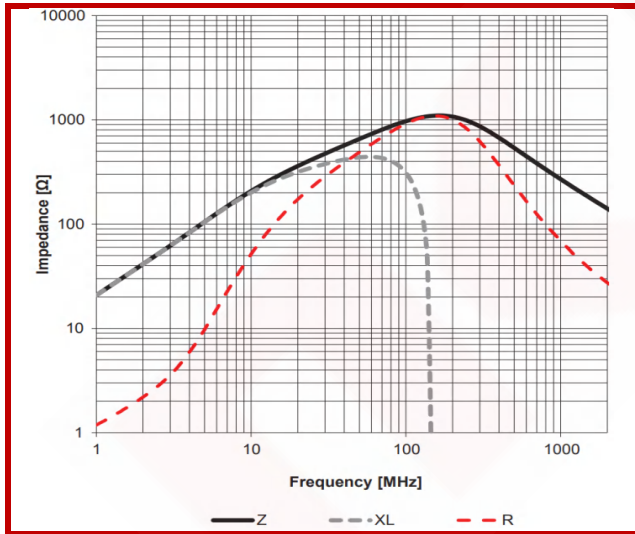



尺寸

Dimension (mm)

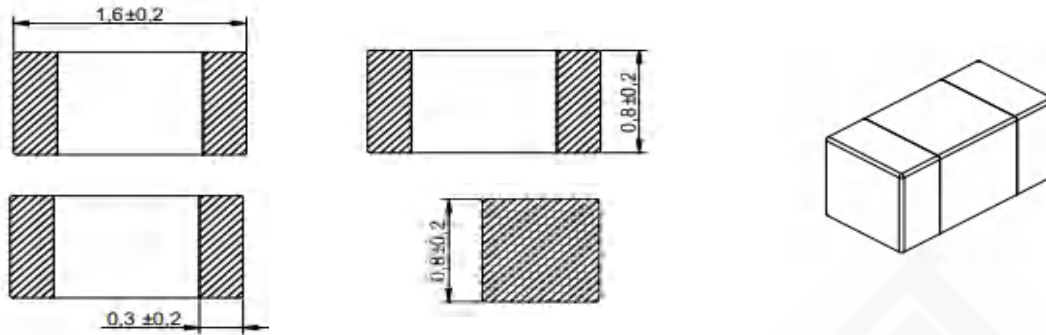

焊盘推荐

Land Pattern Recommended (mm)

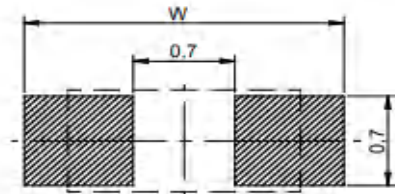

WIDE BAND / HIGH SPEED: W = 2.2
HIGH CURRENT: W = 2.6



示意图

Schematics



电性特性

Electrical Properties

型号 Part No.	阻抗 Impedance Z (Ω)	温升电流 Rated Current I _R 40°C (mA)	直流电阻 DC Resistance DCR _{max} (Ω)	卷盘数量 Taping Reel Qty. pcs
FB1608-101	100 ±25%	1,650	0.150	4,000
FB1608-121	120 ±25%	1,350	0.300	
FB1608-181	180 ±25%	1,500	0.300	
FB1608-221	220 ±25%	1,000	0.300	
FB1608-241	240 ±25%	1,800	0.400	
FB1608-471	470 ±25%	980	0.350	
FB1608-601	600 ±25%	850	0.600	
FB1608-751	750 ±25%	900	0.850	

测试状态

Test Condition

- ☆ 阻抗测试条件为 100MHz (25°C)
Impedance measure condition at 100MHz (25°C)
- ☆ 工作温度: -55°C ~ +125°C
Operating Temperature: -55°C ~ +125°C



尺寸

Dimension (mm)

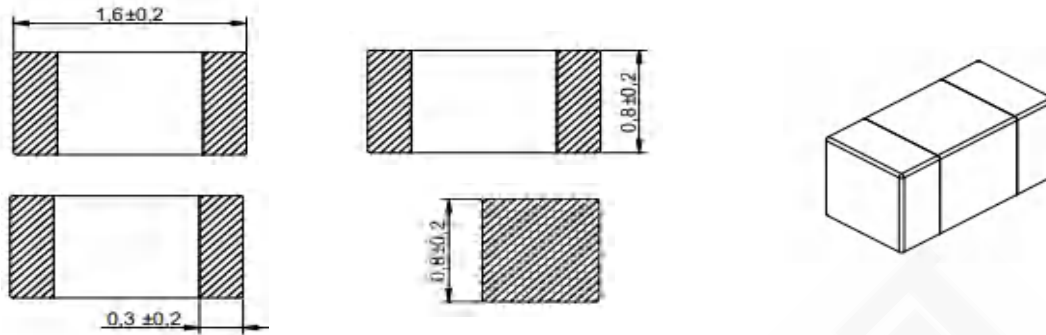

焊盘推荐

Land Pattern Recommended (mm)

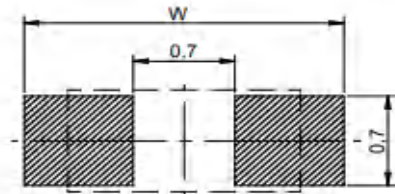

WIDE BAND / HIGH SPEED: W = 2.2
HIGH CURRENT: W = 2.6



示意图

Schematics



电性特性

Electrical Properties

型号 Part No.	阻抗 Impedance Z (Ω)	温升电流 Rated Current I _R 40°C (mA)	直流电阻 DC Resistance DCR _{max} (Ω)	卷盘数量 Taping Reel Qty. pcs
FB1608-102	1,000 ±25%	650	0.600	4,000
FB1608-122	1,200 ±25%	650	0.700	
FB1608-152	1,500 ±25%	650	0.700	
FB1608-182	1,800 ±25%	500	0.800	
FB1608-222	2,200 ±25%	500	0.800	
FB1608-252	2,500 ±25%	450	1.000	

测试状态

Test Condition

- ☆ 阻抗测试条件为 100MHz (25°C)
Impedance measure condition at 100MHz (25°C)
- ☆ 工作温度: -55°C ~ +125°C
Operating Temperature: -55°C ~ +125°C



典型阻抗特性

Typical Impedance Characteristics

FB1608-101

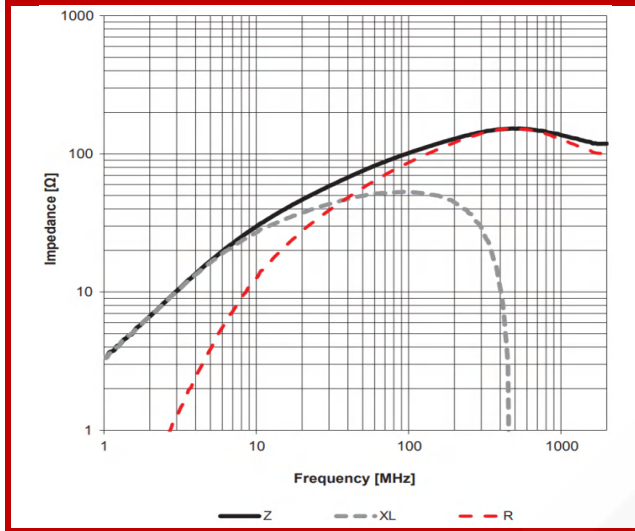

FB1608-121

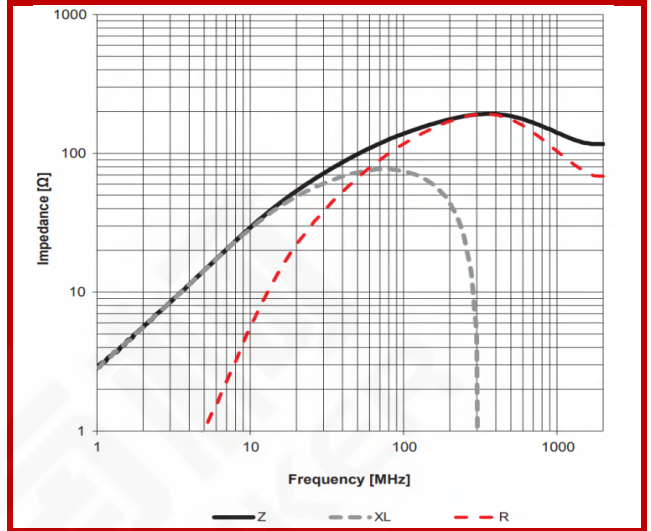

FB1608-181

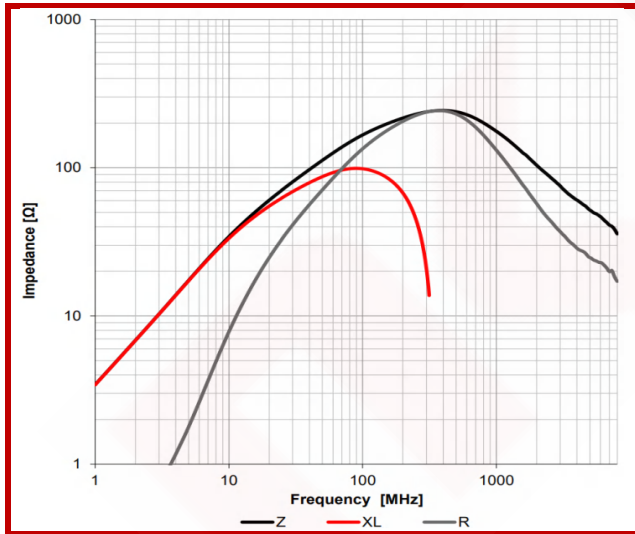

FB1608-221

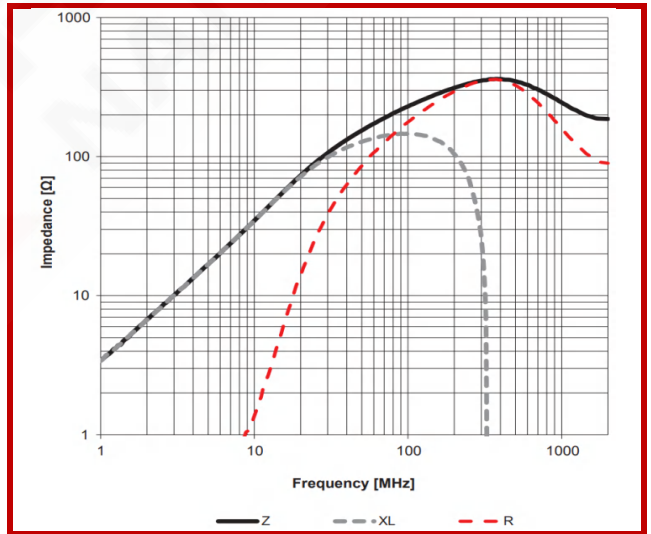

FB1608-241

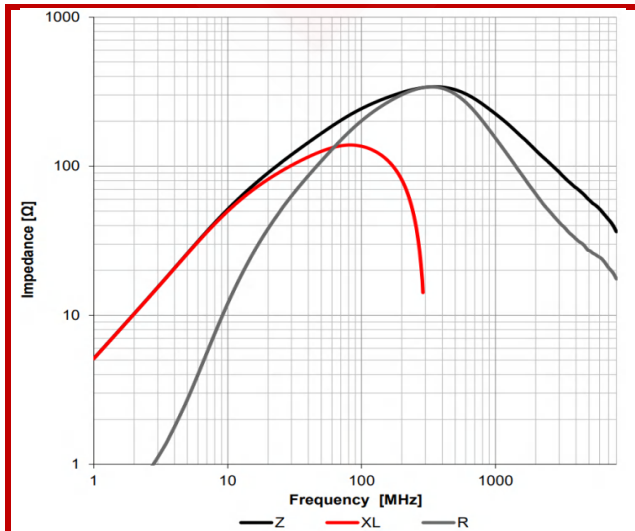

FB1608-471

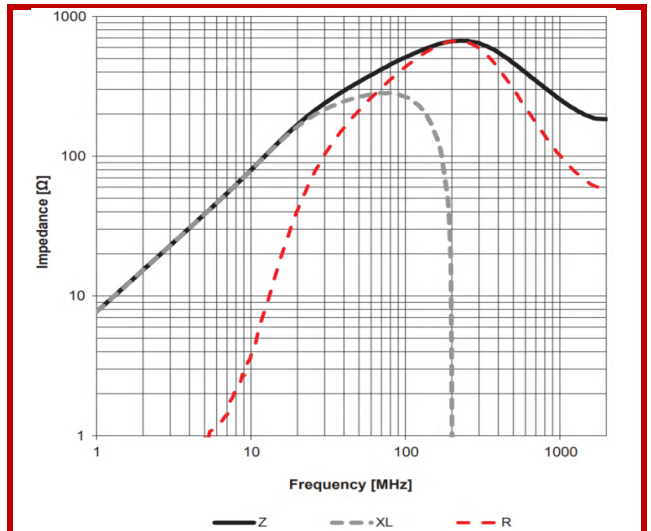



典型阻抗特性

Typical Impedance Characteristics

FB1608-601

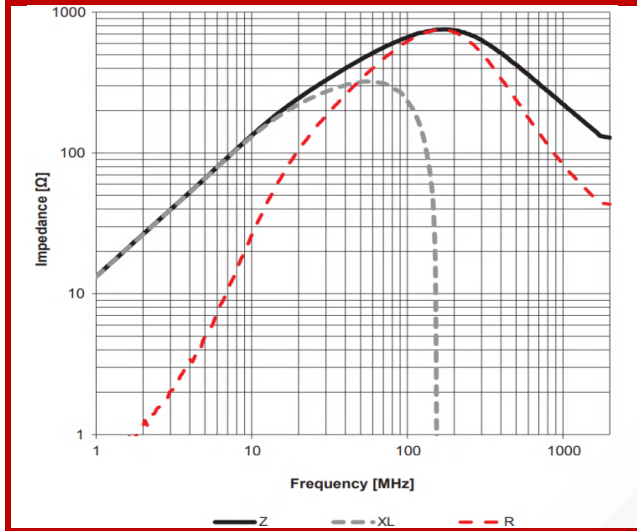

FB1608-751

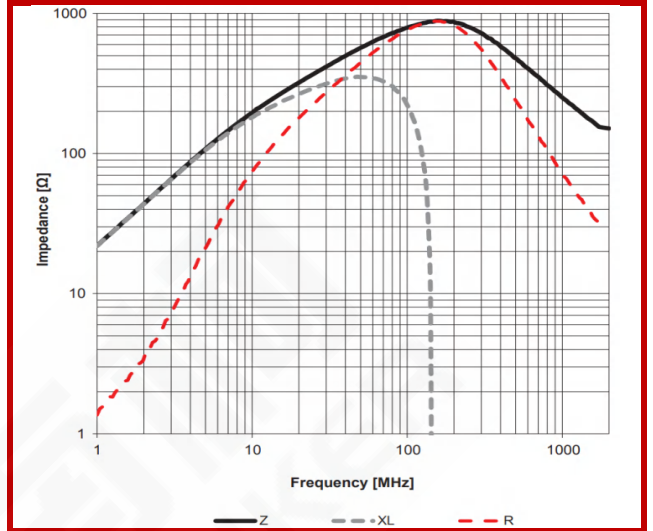

FB1608-102

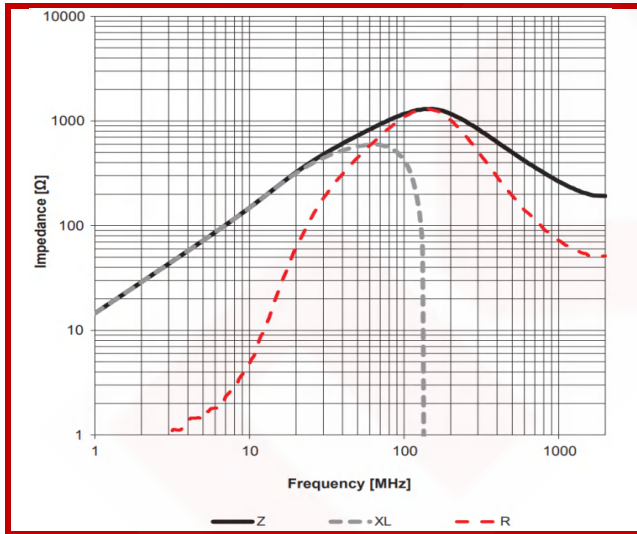

FB1608-122

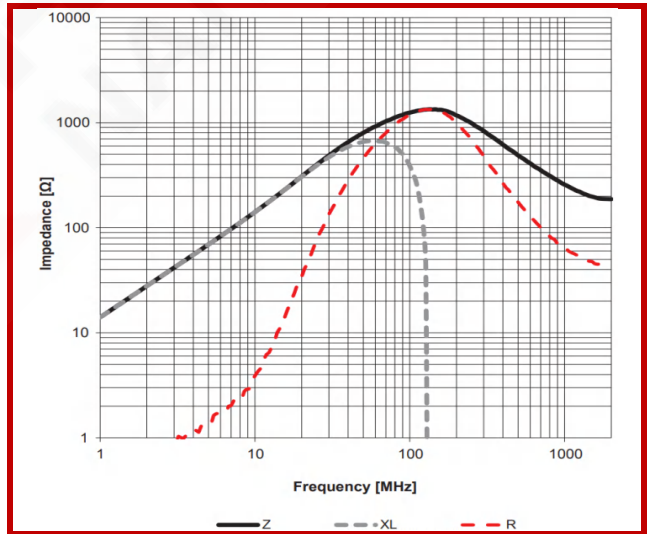

FB1608-152

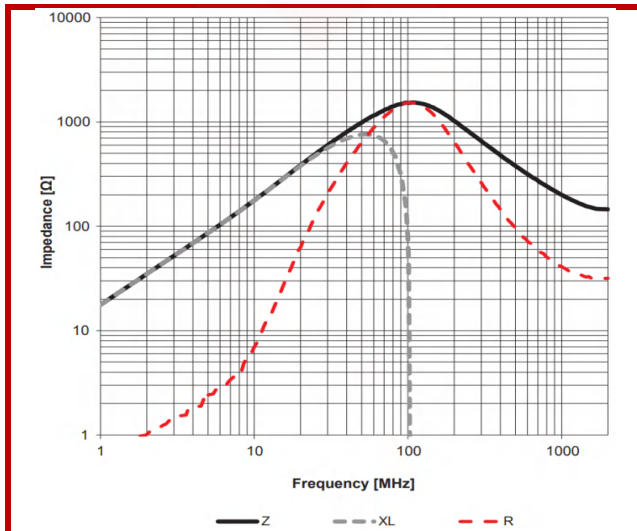

FB1608-182

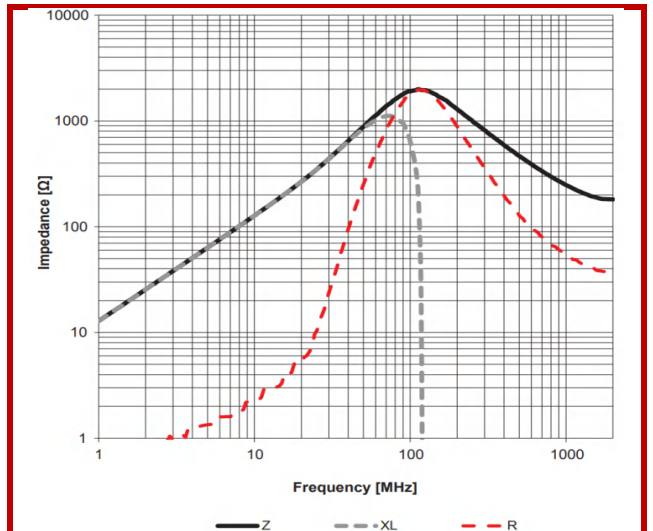



典型阻抗特性

Typical Impedance Characteristics

FB1608-222

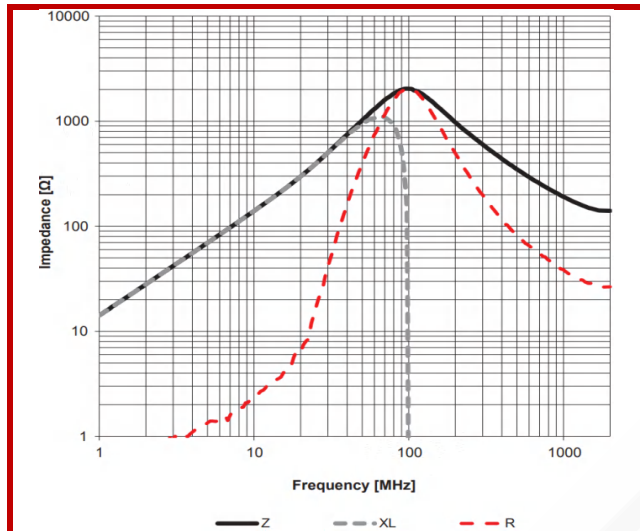

FB1608-252

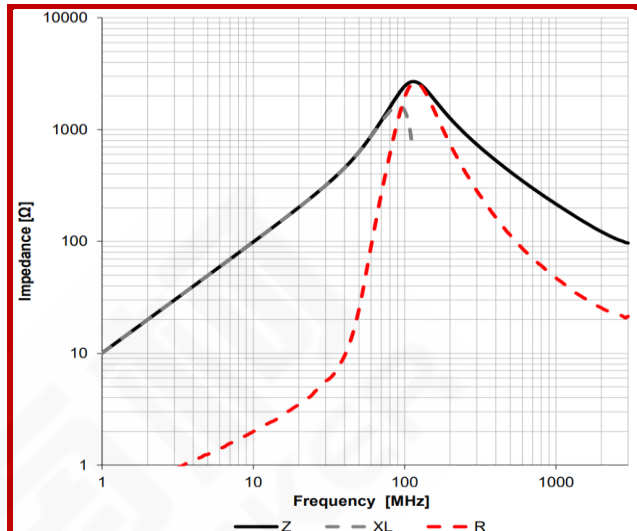



尺寸

Dimension (mm)

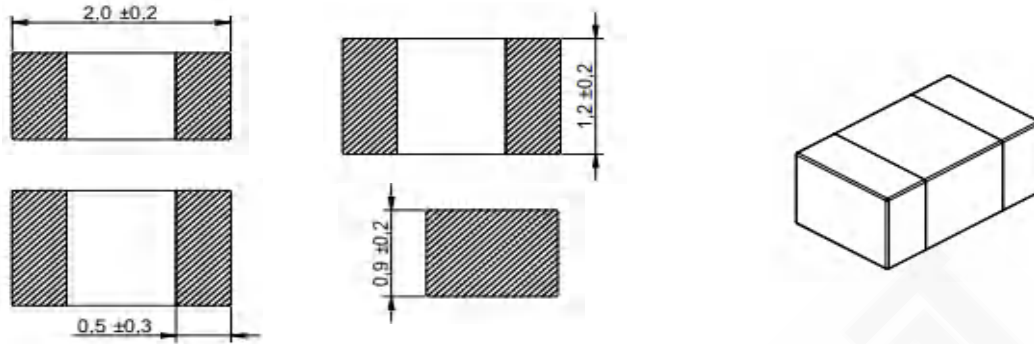

焊盘推荐

Land Pattern Recommended (mm)

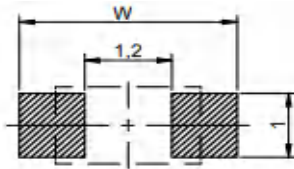

WIDE BAND / HIGH SPEED: W = 3,0
HIGH CURRENT: W = 4,0



示意图

Schematics



电性特性

Electrical Properties

型号 Part No.	阻抗 Impedance Z (Ω)	温升电流 Rated Current I _R 40°C (mA)	直流电阻 DC Resistance DCR _{max} (Ω)	卷盘数量 Taping Reel Qty. pcs
FB2012-560	56 ±25%	1,800	0.300	4,000
FB2012-800	80 ±25%	3,100	0.200	
FB2012-241	240 ±25%	1,400	0.400	
FB2012-401	400 ±25%	1,500	0.300	
FB2012-471	470 ±25%	1,800	0.300	
FB2012-601	600 ±25%	1,500	0.350	
FB2012-102	1,000 ±25%	900	0.450	
FB2012-122	1,200 ±25%	1,200	0.550	
FB2012-152	1,500 ±25%	1,000	0.550	
FB2012-182	1,800 ±25%	1,000	0.400	
FB2012-202	2,000 ±25%	800	0.600	
FB2012-222	2,200 ±25%	1,000	0.600	
FB2012-272	2,700 ±25%	1,000	0.600	

测试状态

Test Condition

- ☆ 阻抗测试条件为 100MHz (25°C)
Impedance measure condition at 100MHz (25°C)
- ☆ 工作温度: -55°C ~ +125°C
Operating Temperature: -55°C ~ +125°C



典型阻抗特性

Typical Impedance Characteristics

FB2012-560

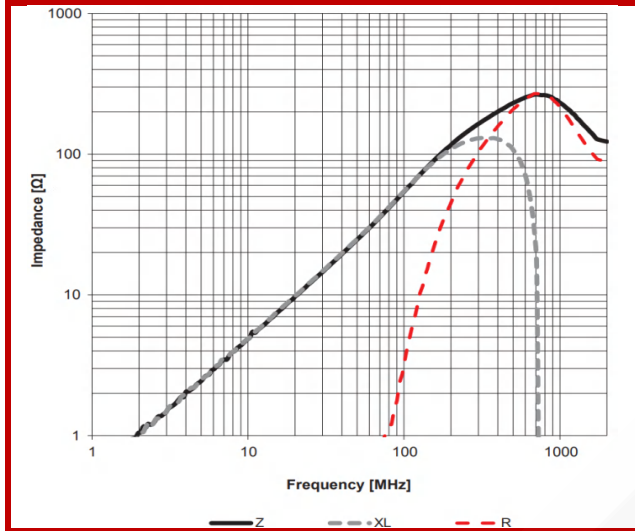

FB2012-800

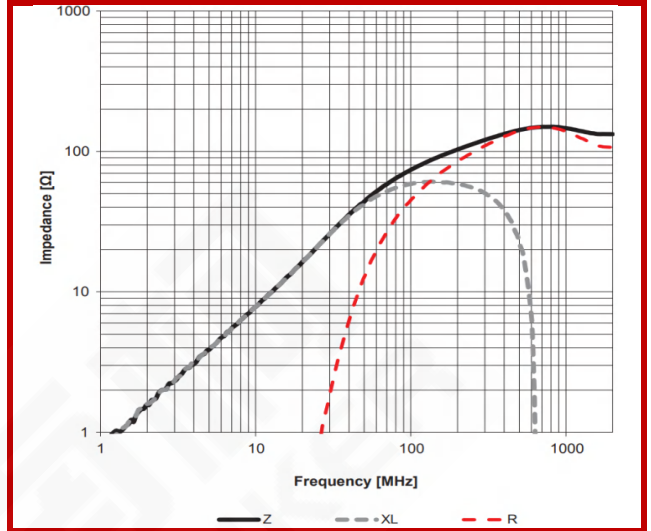

FB2012-241

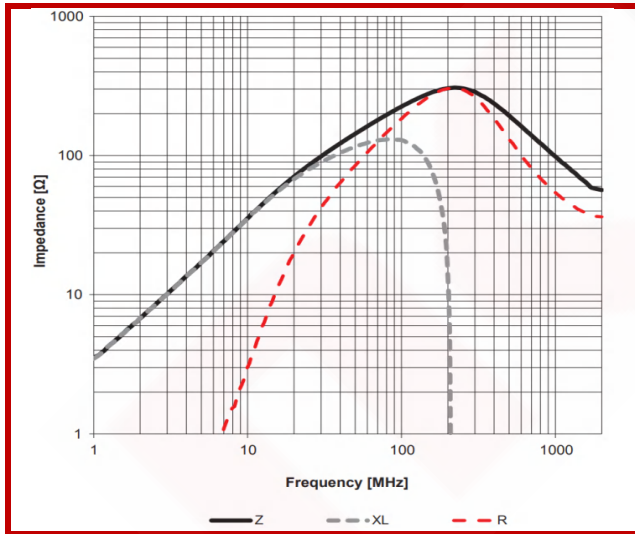

FB2012-401

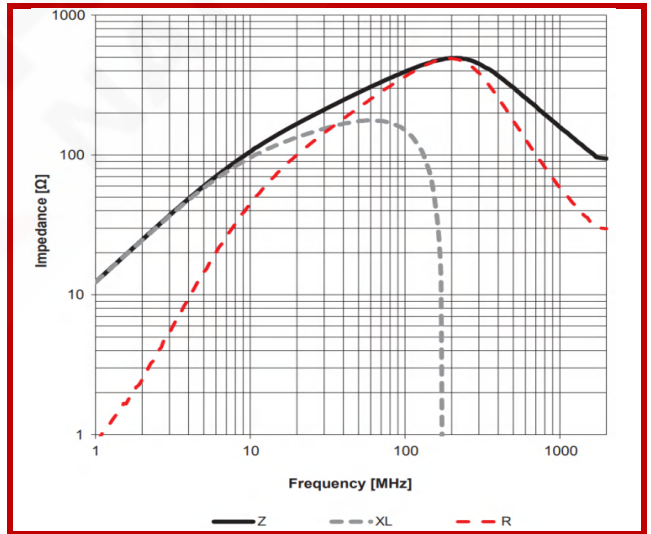

FB2012-471

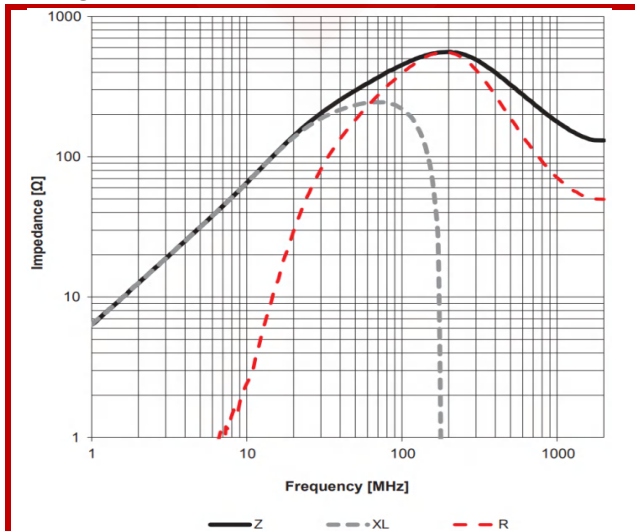

FB2012-601

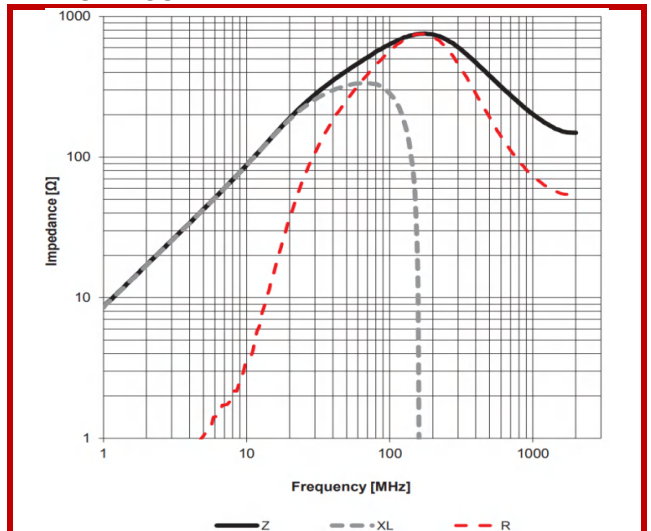



典型阻抗特性

Typical Impedance Characteristics

FB2012-102

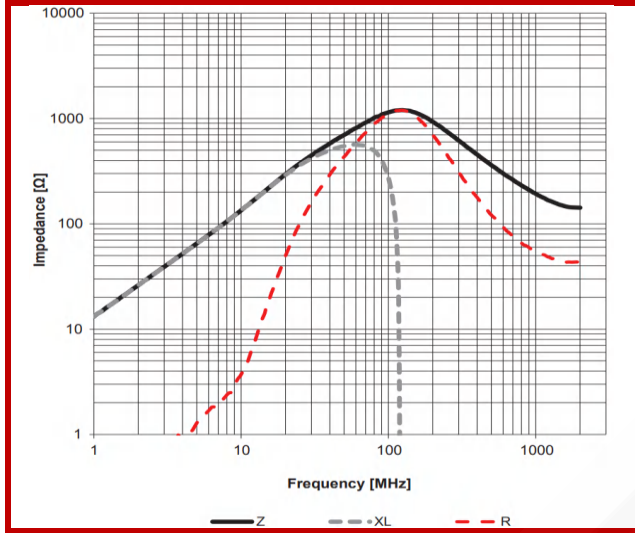

FB2012-122

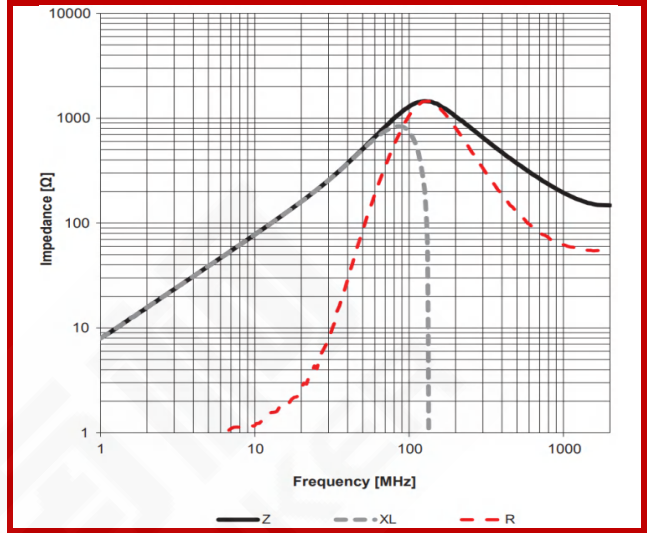

FB2012-152

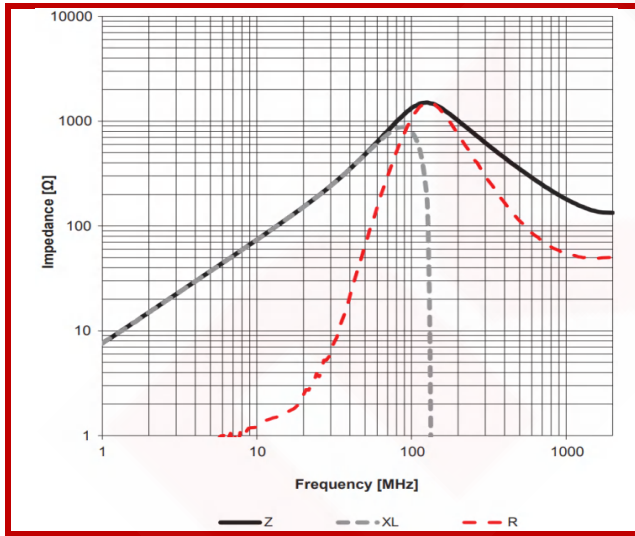

FB2012-182

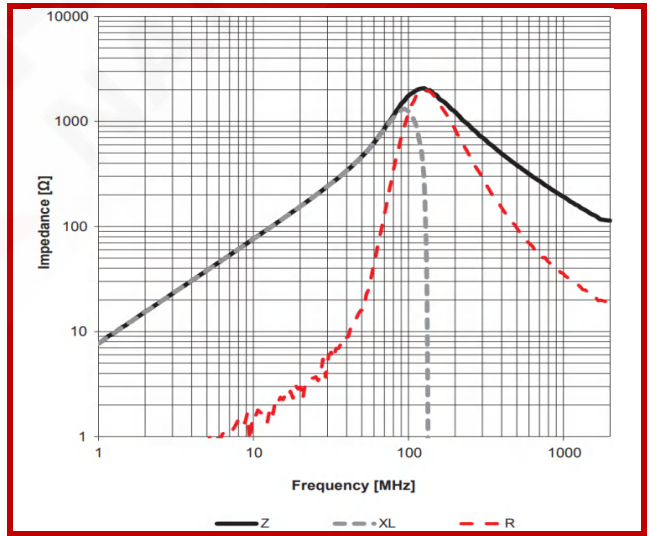

FB2012-202

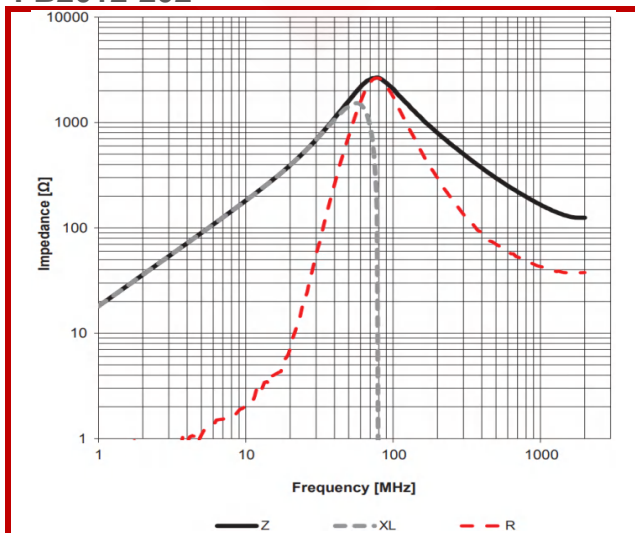

FB2012-222

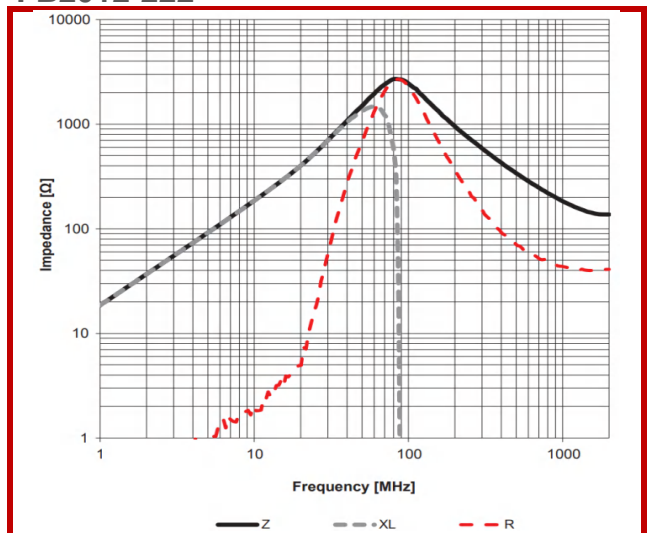



典型阻抗特性

Typical Impedance Characteristics

FB2012-272

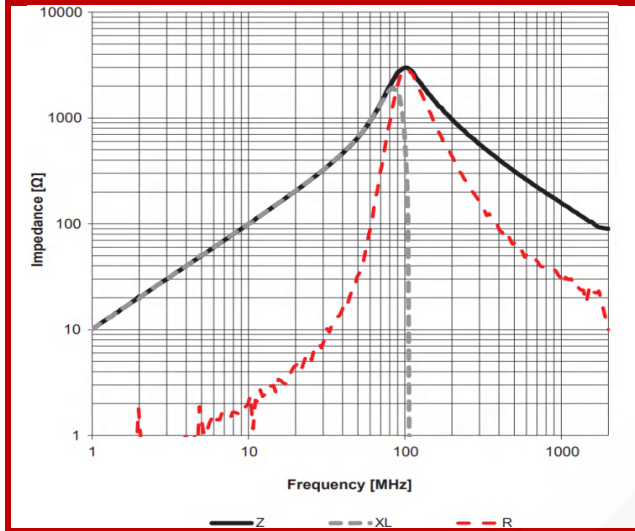



尺寸

Dimension (mm)

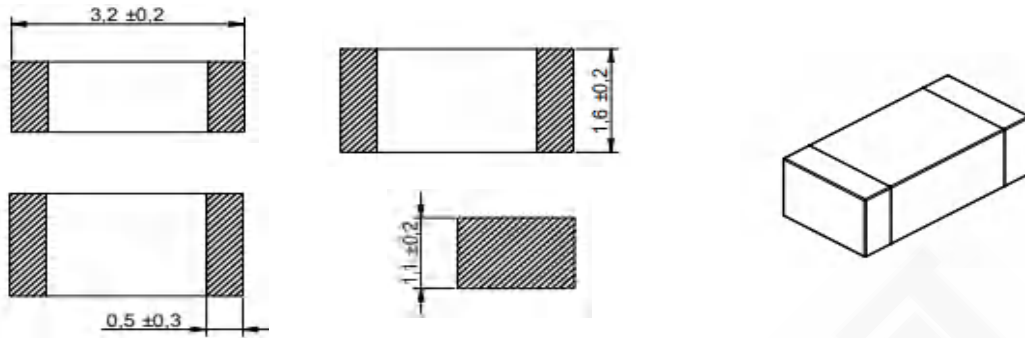

焊盘推荐

Land Pattern Recommended (mm)

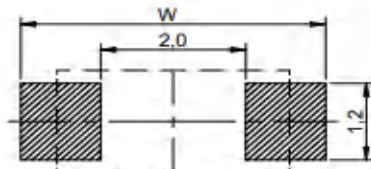

WIDE BAND / HIGH SPEED: W = 4.2
HIGH CURRENT: W = 5.2



示意图

Schematics



电性特性

Electrical Properties

型号 Part No.	阻抗 Impedance Z (Ω)	温升电流 Rated Current I _R 40°C (mA)	直流电阻 DC Resistance DCR _{max} (Ω)	卷盘数量 Taping Reel Qty. pcs
FB3216-471	470 ±25%	2,700	0.300	4,000
FB3216-601	600 ±25%	2,600	0.300	
FB3216-701	700 ±25%	450	0.650	
FB3216-100	1,000 ±25%	1,300	0.450	
FB3216-102	1,000 ±25%	1,300	0.500	

测试状态

Test Condition

- ☆ 阻抗测试条件为 100MHz (25°C)
Impedance measure condition at 100MHz (25°C)
- ☆ 工作温度: -55°C ~ +125°C
Operating Temperature: -55°C ~ +125°C



典型阻抗特性

Typical Impedance Characteristics

FB3216-471

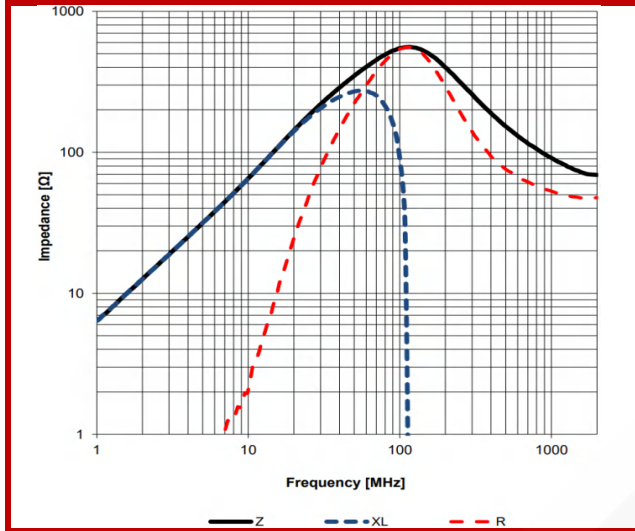

FB3216-601

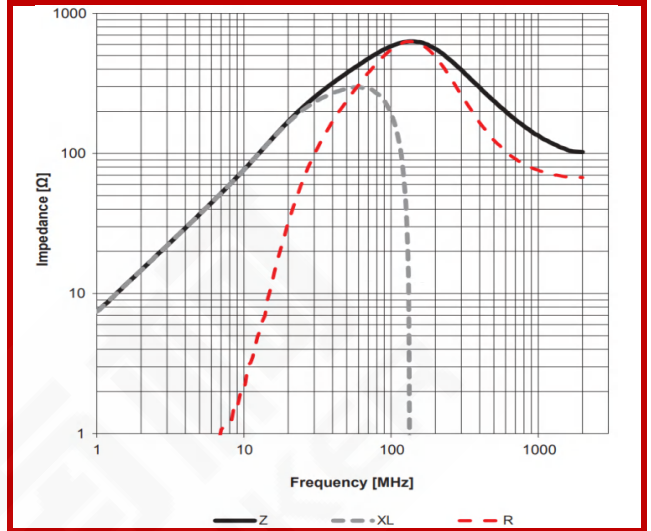

FB3216-701

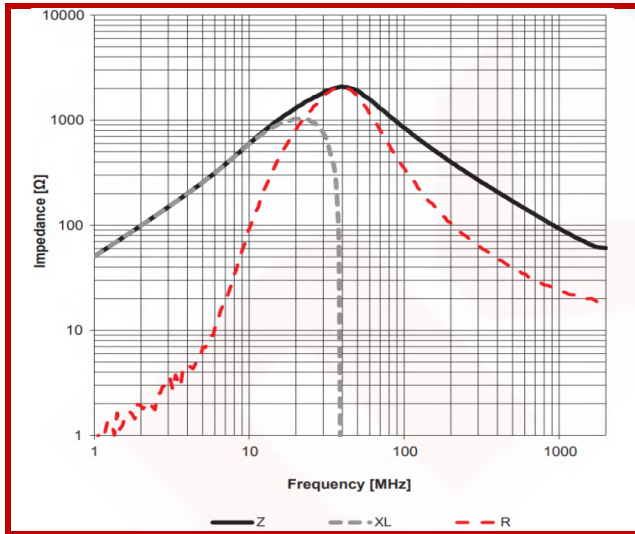

FB3216-102

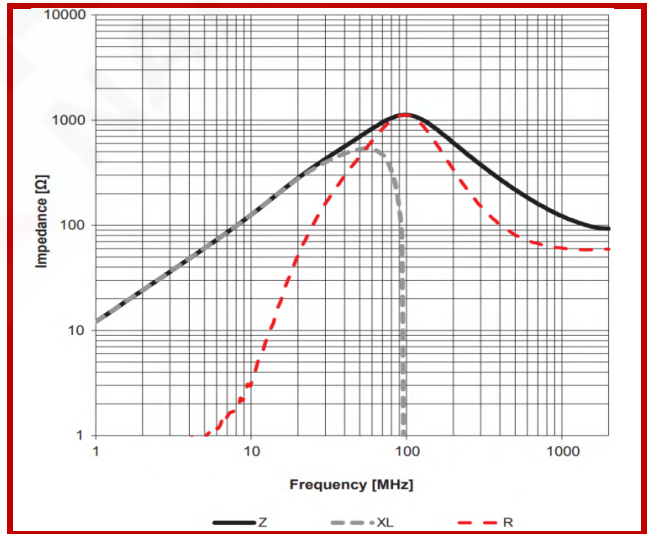

FB3216-122

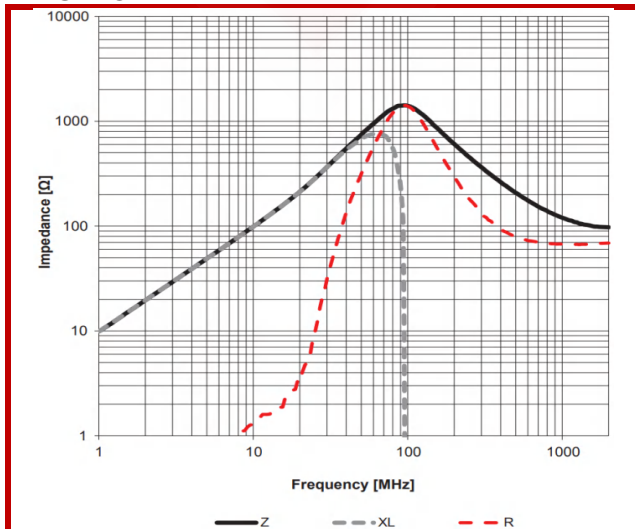



尺寸

Dimension (mm)

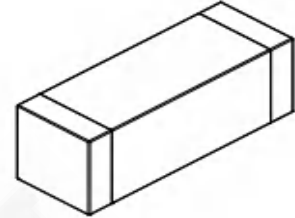
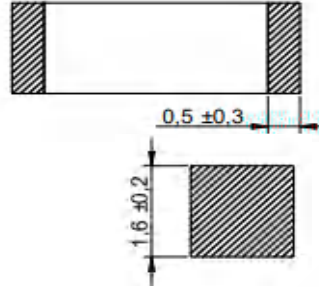
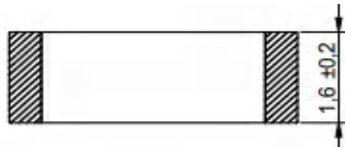
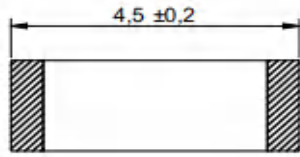

焊盘推荐

Land Pattern Recommended (mm)

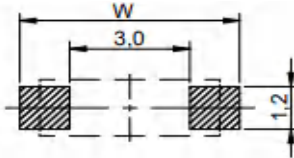

示意图

Schematics



WIDE BAND / HIGH SPEED: W = 5,5
HIGH CURRENT: W = 6,5



电性特性

Electrical Properties

型号 Part No.	阻抗 Impedance Z (Ω)	温升电流 Rated Current I _R 40°C (mA)	直流电阻 DC Resistance DCR _{max} (Ω)	卷盘数量 Taping Reel Qty. pcs
FB4516-151	150 ±25%	2,000	0.500	2,000
FB4516-102	1,000 ±25%	1,500	0.090	

测试状态

Test Condition

- ☆ 阻抗测试条件为 100MHz (25°C)
Impedance measure condition at 100MHz (25°C)
- ☆ 工作温度: -55°C ~ +125°C
Operating Temperature: -55°C ~ +125°C



典型阻抗特性

Typical Impedance Characteristics

FB4516-151

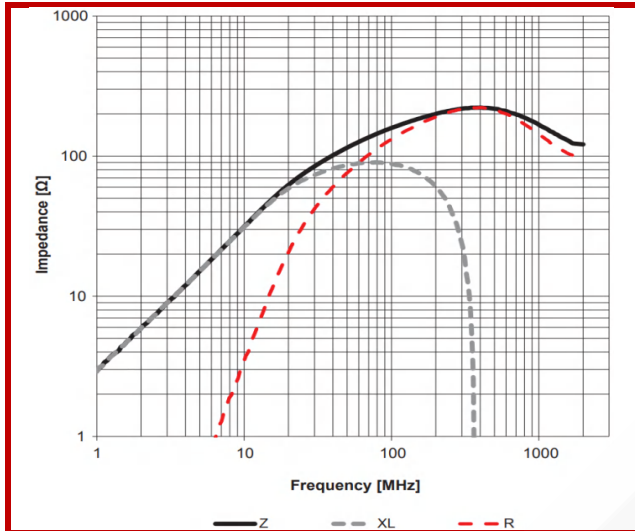

FB4516-102

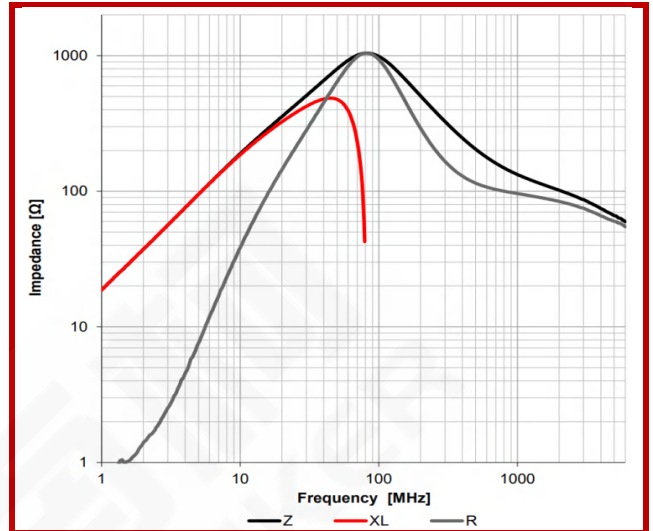



尺寸

Dimension (mm)

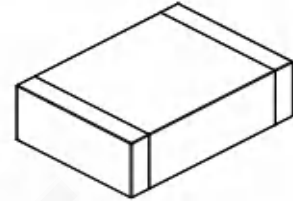
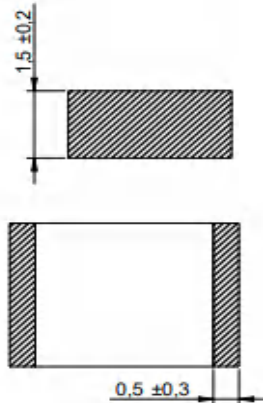
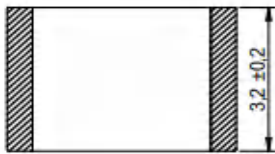
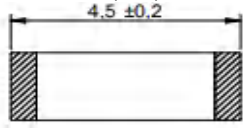

焊盘推荐

Land Pattern Recommended (mm)

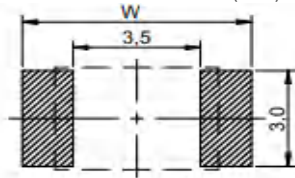

WIDE BAND / HIGH SPEED: W = 6.3
HIGH CURRENT: W = 7.3



示意图

Schematics



电性特性

Electrical Properties

型号 Part No.	阻抗 Impedance Z (Ω)	温升电流 Rated Current I _R 40°C (mA)	直流电阻 DC Resistance DCR _{max} (Ω)	卷盘数量 Taping Reel Qty. pcs
FB4532-700	70 ±25%	6,000	0.300	1,000

测试状态

Test Condition

- ☆ 阻抗测试条件为 100MHz (25°C)
Impedance measure condition at 100MHz (25°C)
- ☆ 工作温度: -55°C ~ +125°C
Operating Temperature: -55°C ~ +125°C



典型阻抗特性

Typical Impedance Characteristics

FB4532-700

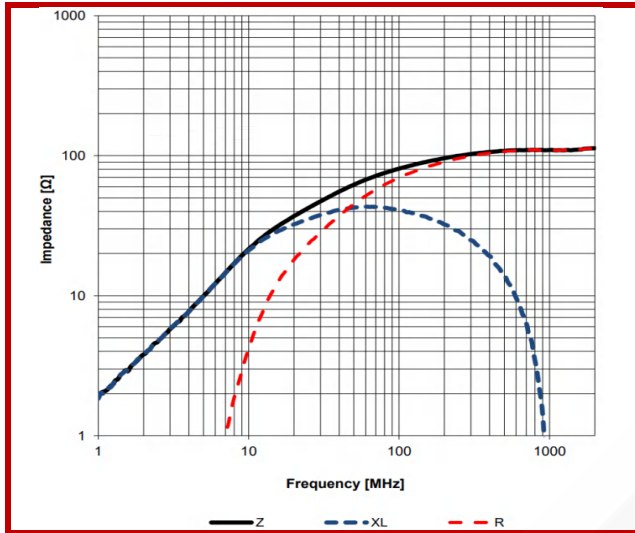



回流焊曲线图

Classification Reflow Profile for SMT Components

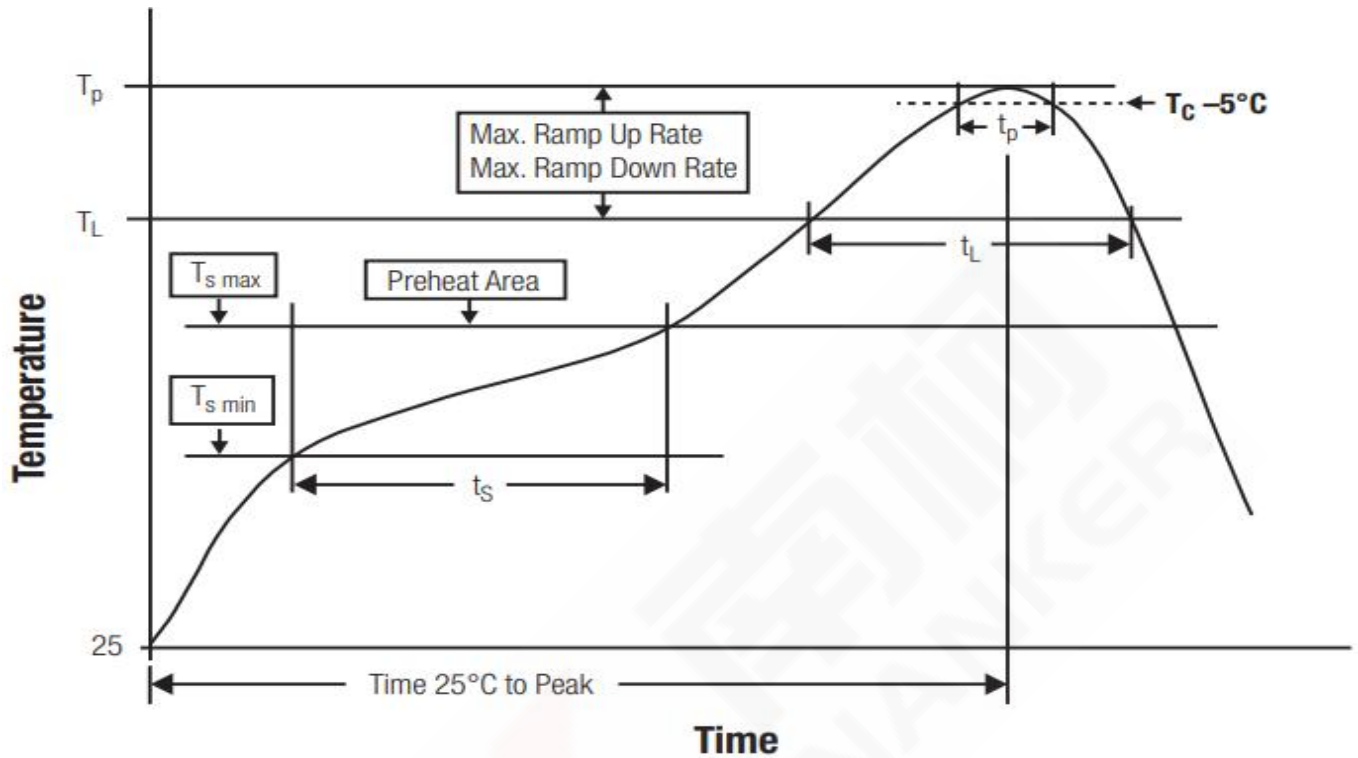

封装体峰值温度(Tp)分类

Classification Reflow Soldering Profile:

	封装厚度 Package Thickness	封装体积 Package Volume		
		<350 mm ³	350~2,000 mm ³	>2,000 mm ³
无铅装配 PB-Free Assembly	<1.60mm	260°C	260°C	260°C
	1.60~2.50mm	260°C	250°C	245°C
	>2.50mm	260°C	245°C	245°C

- ◆ 回流焊参照标准 IPC/JEDEC J-STD-020D。
Reflow is refer to standard IPC/JEDEC J-STD-020D.